

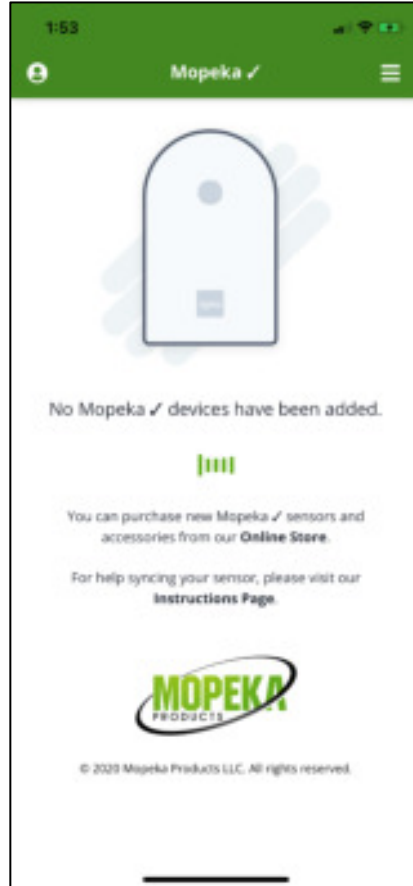

Pro Water Sensor Instructions

Smart Device/App Users

1. Go to your app store. Search for Mopeka Tank Check app and install.
2. Launch the app. When it starts it will automatically start a search for Mopeka ✓ sensors.



3. Press and hold SYNC button until sensor appears on app. (up to 10 seconds)

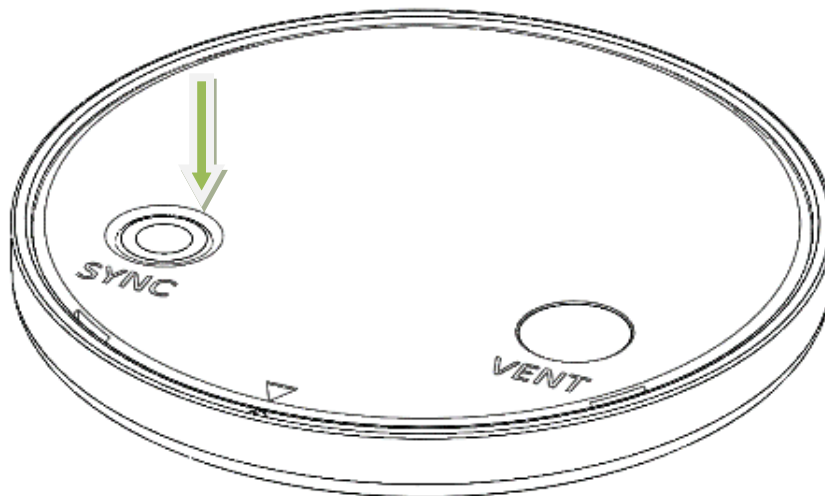



Pro Water Sensor Instructions

4. The sensor will then appear on your app as a new device.
5. Sensor is now Sync'd. You may now proceed to installing the sensor on the tank.





Pro Water Sensor Instructions

Install Sensor on Tank

6. Clean the bottom of the tank of any debris, etc.
7. See graphic below for recommended installation location on bottom of water tank.
8. Now apply provided primer to the area of the tank that will be contacted by the adhesive on the collar. Squeeze the primer tube as shown on primer, to release flow of primer.
9. Peel paper from adhesive on the collar and press the collar firmly on the tank. Press firmly on every collar flange to ensure adhesive makes good contact and is properly activated.
10. Apply a generous amount of the supplied dielectric grease directly to the sensor pad before attaching sensor to the tank.
11. Install sensor into collar with Sync button facing away from tank. Black rubber contact pad should make contact with tank bottom.
12. Install snap ring over the sensor and collar to retain sensor.

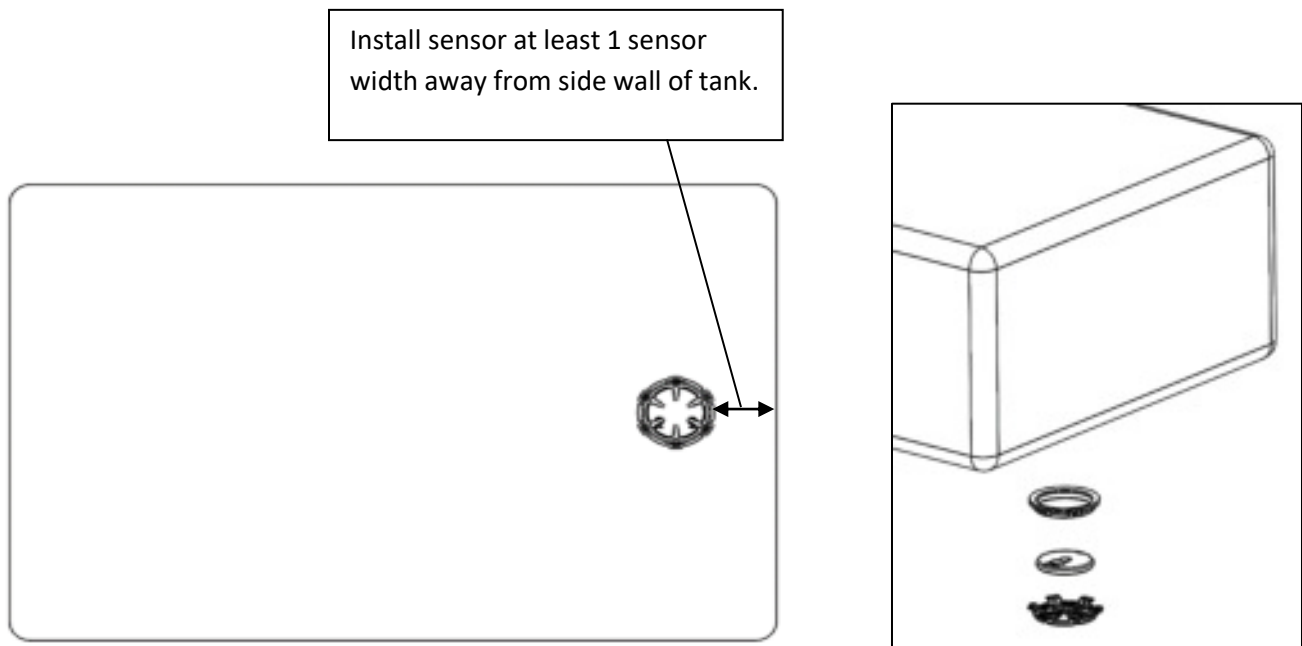

Rubber Pad

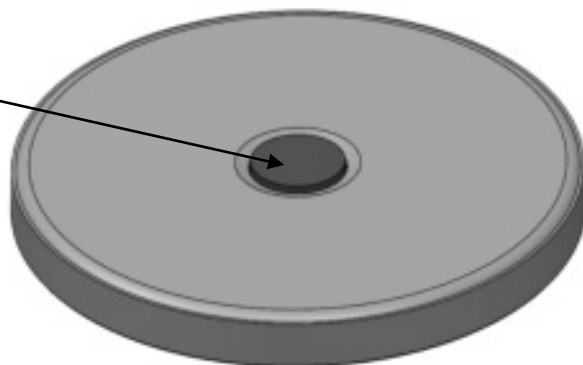



Pro Water Sensor Instructions

Using the App & Sensor

App Users:

13. Clicking on a sensor in the main list takes you to the sensor's own screen. Most information is self-explanatory. Click on the settings icon (upper right) to change settings or rename your sensor.
14. Be sure to go to the tank size setting and enter the overall height of the water tank.